

# Strand pelletizer

## ips-SG-E 30 / Kombi

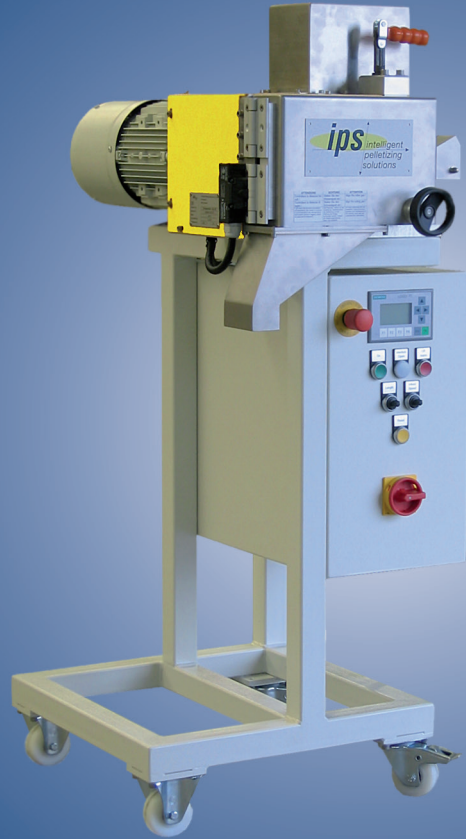

- Optimized for use in laboratories and/or small-batch production
- Draw-in and cutting width 30 mm for throughputs up to 150 kg/h
- Solid, compact design
- Clear design of the control panel – integrated in the switch cabinet
- Innovative, easy setting of the cutting gap
- Cantilevered design of cutting and draw-in section for optimum accessibility and cleaning
- Easy operation
- Available as ips-SG-E 30 Kombi strand pelletizer with strand cooling trough and strand drying

**Option:** Minimum draw-in speed from 1 m/min

**Option:** Pneumatic pressure on the upper feed roller

**Option:** Online pellet length adjustment

**Option:** Can be operated from the left or right

**Option:** Pneumatic door locking (instead of time-delay safety lock)

**Option:** Interfaces for signal exchange and remote control

**Option:** Can be adjusted to customers' requirements at any time

## Design details

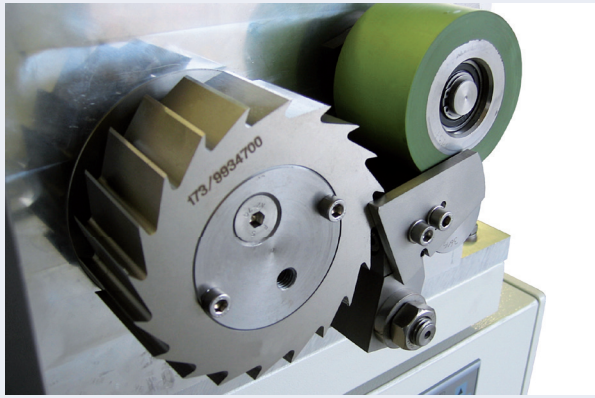

Cantilevered design of cutting and draw-in section

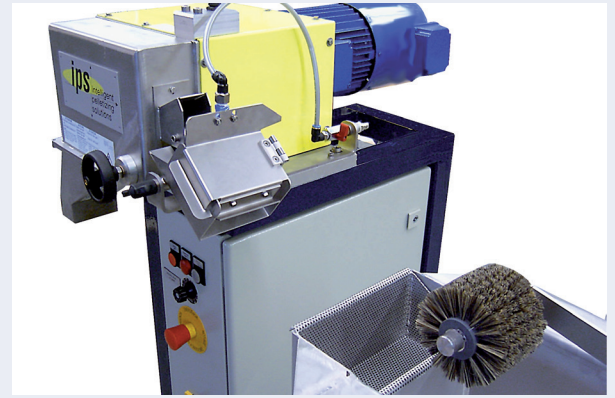

Strand feed guide with integrated strand dewatering by blowing (ips-SG-E 30 Kombi)

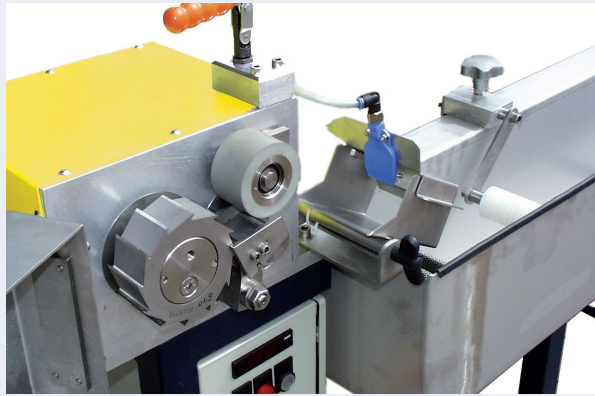

Low-deposit cutting area for fast product changeover (ips-SG-E 30 Kombi)



Clear operating and display elements

## Options and accessories

ips systems are available with a range of options and accessories. We will be happy to advise you on the systems we offer, and the additions that will be best for you.



**Option:** Online pellet length adjustment



**Option:** ips-SG-E 30 Kombi Integrated strand dewatering by suction

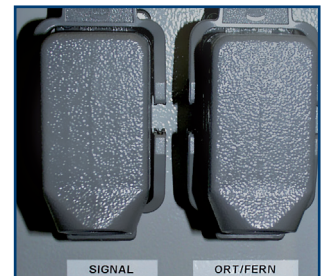

**Option:** Interfaces for signal exchange and remote control



**Option:** Online pellet length adjustment



**Option:** Operation from left or right

## Options and accessories

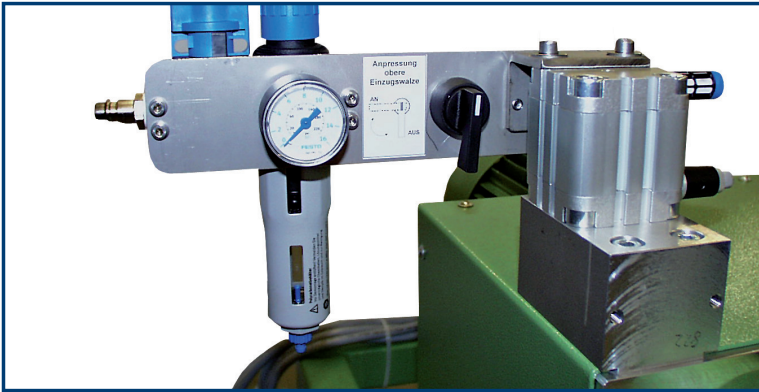

**Option:**  
Pneumatic pressure  
on the upper feed roller

## Strand pelletizer Type ips-SG-E 30 Kombi



Strand pelletizer with integrated strand cooling trough 2 to 4 m in length with the option of efficient strand drying by blowing (standard) or suction;  
Small dimensions and good accessibility – ideally suited to laboratory use and/or small-batch production;

The strand cooling trough can easily be decoupled – the ips-SG-E 30 strand pelletizer can be used as a stand-alone machine

All parts in contact with water are of stainless steel;  
Strand guide rollers mounted on one side for optimum accessibility and easy re-threading;  
Very stable, thick-walled trough design;

Sub-frame can be painted, galvanized or stainless steel as requested

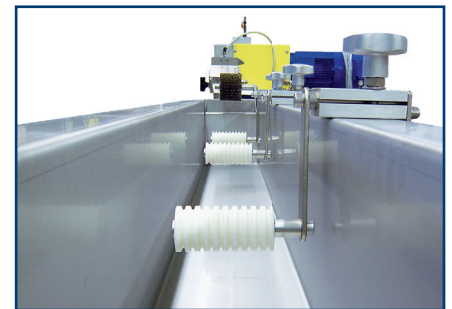

## Technical data

Size	ips-SG-E 30	ips-SG-E 30 Kombi
Draw-in and cutting width (mm)	30	30
Drive	Three-phase motor with inverter	
Power (kW)	1.5	1.5
Draw-in speed range (m/min.) <i>with a pellet length of 3 mm</i>	20 – 80 Optional 5 – 55	20 – 80 Optional 5 – 55
Max. number of strands <i>with a strand diameter of 3 mm</i>	5	5
Other	Standard pellet length: 3 mm <b>or</b> optional infinitely adjustable online pellet length setting from 1.5 to 3.5 mm	



Option:  
Interface for  
data exchange



Option:  
Pneumatic pressure  
on the upper feed roller

## Throughput data

Versions:	For production: max. draw-in speed 80 m/min; 5 strands	For the laboratory: min. 1 strand at 5 m/min max. 5 strands at 55 m/min
PE, PP (kg/h)	110	1 – 75
GPPS, SAN (kg/h)	130	2 – 85
HIPS, ABS (kg/h)	130	2 – 85
PMMA (kg/h)	150	2 – 100
PC (kg/h)	150	2 – 100
PET, PBT (kg/h)	150	2 – 100
PA 6, PA 6.6 (kg/h)	130	2 – 85
PA 6.6, PET, PBT + 10 – 50 % glass fibre (kg/h)	120	1 – 80
Thermoplastic elastomers (kg/h)	130	2 – 85
Masterbatch on the basis of engineering polymers from 40 % fill level (kg/h)	150	2 – 100

Throughput data depends on:

Pellet length, pellet diameter, draw-in speed, number of strands, power, cooling time before cut, etc.

## Dimensions

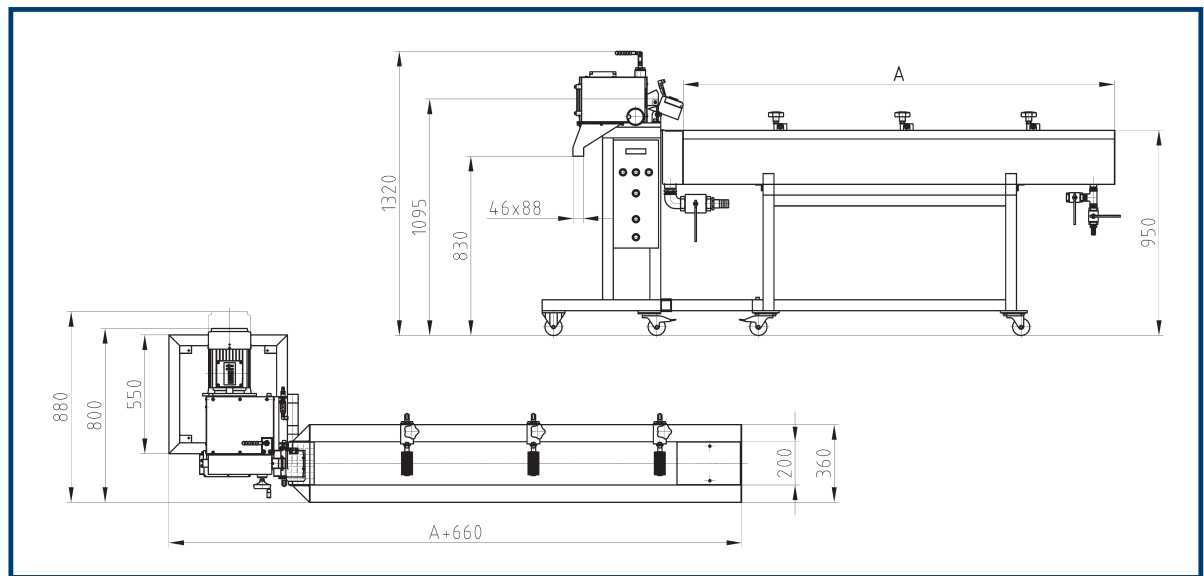

Size	ips-SG-E 30	ips-SG-E 30 Kombi
Length A (mm) approx.	-	2,000/3,000/4,000
Length (mm) approx.	550	A + 660
Width (mm) approx.	800	880
Width of strand cooling trough (mm) approx.	-	360
Usable width of strand cooling trough (mm) approx.	-	200
Height of strand cooling trough (mm) approx.	-	950
Dimensions of pellet outlet (mm) approx.	88 x 45	88 x 45
Weight (kg) approx.	115	200/225/250
Height (mm) approx.	1,320	1,320
Height of strand intake (mm) approx.	1,095	1,095
Height of pellet outlet (mm) approx.	830	830

We reserve the right to make changes without notice. The illustrations may include options and accessories that are not part of the standard scope of supply.

